

KIT PROFILI / PROFILES KIT



PROFILO 1813 - fissaggio a parete con molla fissa 14419
- Wall fixing with fixed spring 14419

INFORMAZIONI PRODOTTO:
PRODUCT INFORMATION:

Materiale profilo: Material:	Alluminio / Aluminium
Finitura: Finish:	<input checked="" type="checkbox"/> Alluminio anodizzato / Anodized aluminum <input type="checkbox"/> Bianco / White <input type="checkbox"/> Nero / Black
Materiale diffusore: Diffuser material:	Policarbonato / Polycarbonate
Diffusore: Diffuser:	Opale piano - Opale piano nero - Opale tondo - Opale alto - Prismatico UGR19 Flat opal - Flat black opal - Round opal - High opal - Prismatic UGR19
Contenuto kit: Kit contents:	Profilo+Diffusore+Tappi (1 chiuso e 1 aperto)+Mollette Profile+Diffuser+Caps (1 closed and 1 open)+Clips
Ambiente: Ambient:	Interno / Indoor
Emissione luce: Light emission:	Monoemissione / Single emission
Lunghezze disponibili: Available lengths:	1m - 2m - 3m - 4m
Grado IP: IP grade:	IP20

Unità: mm
Unit: mm

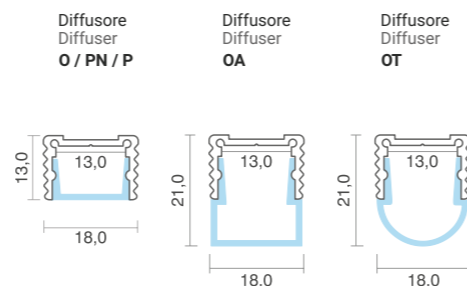

(Fig.1) (Fig.2) (Fig.3)

INSTALLAZIONE / INSTALLATION

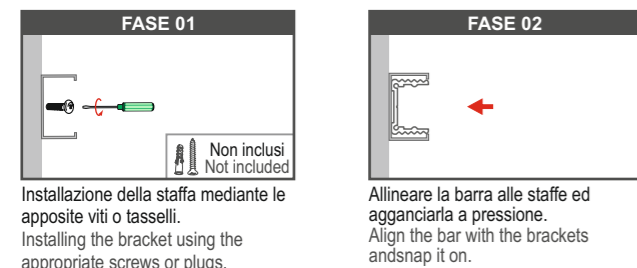

FISSAGGIO / FIXING

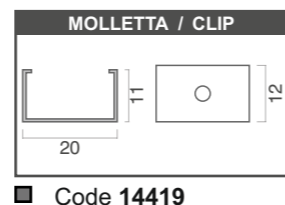

Code 14419

COMPOSIZIONE CODICE KIT
KIT CODE COMPOSITION

COD.BASE BASE CODE:	DIFFUSORE DIFFUSER	FINITURA FINISH	LUNGHEZZA LENGTH
1813-	O (opale piano/flat opal)	00 (alluminio/aluminium)	L10 (1000mm)
	PN (opale piano nero/flat black opal)	01 (bianco/white)	L20 (2000mm)
	OT (opale tondo/round opal)	02 (nero/black)	L30 (3000mm)
	OA (opale alto/high opal)		L40 (4000mm)
	P (prismatico UGR19/prismatic)		

OPZIONALE / OPTIONAL

14071
Touch SMD 12~24V (disponibile solo per copertura piana)
Touch SMD 12~24V (only available for flat cover)

CODICI COMPONENTI SINGOLI / SINGLE COMPONENTS CODES

PROFILO 1813

PROFILO/PROFILE

14178-L10 / 14178-L20 / 14178-L30 / 14178-L40 ■
Alluminio L=1m/2m/3m/4m
Aluminum L=1m/2m/3m/4m
14178-01L10 / 14178-01L20 / 14178-01L30 / 14178-01L40 □
Bianco L=1m/2m/3m/4m
White L=1m/2m/3m/4m
14178-02L10 / 14178-02L20 / 14178-02L30 / 14178-02L40 ■
Nero L=1m/2m/3m/4m
Black L=1m/2m/3m/4m

DIFFUSORE/DIFFUSER

14281-L10 / 14281-L20 / 14281-L30 / 14281-L40
Opale piano L=1m/2m/3m/4m
Flat opal L=1m/2m/3m/4m
14884-L10 / 14884-L20 / 14884-L30 / 14884-L40 □
Opale piano nero L=1m/2m/3m/4m
Flat black opal L=1m/2m/3m/4m
14655-L10 / 14655-L20 / 14655-L30 / 14655-L40 ■
Prismatico L=1m/2m/3m/4m
Prismatic L=1m/2m/3m/4m

14929-L10 / 14929-L20 / 14929-L30 / 14929-L40 □
Opale alto L=1m/2m/3m/4m
High opal L=1m/2m/3m/4m

14016-L10 / 14016-L20 / 14016-L30 / 14016-L40 □
Opale tondo L=1m/2m/3m/4m
Round opal L=1m/2m/3m/4m

TAPPI/CAPS

13210 / 13211 ■
Alluminio: passacavo e chiuso
Aluminum: grommet and closed
13210-01 / 13211-01 □
Bianchi: passacavo e chiuso
White: grommet and closed
13210-02 / 13211-02 ■
Neri: passacavo e chiuso
Black: grommet and closed

14212 / 14213 ■
Tappi alluminio: passacavo e chiuso per diffusore 14929
Aluminum caps: grommet and closed for diffuser 14929
14212-01 / 14213-01 □
Tappi bianchi: passacavo e chiuso per diffusore 14929
White caps: grommet and closed for diffuser 14929
14212-02 / 14213-02 ■
Tappi neri: passacavo e chiuso per diffusore 14929
Black caps: grommet and closed for diffuser 14929

14231 / 14232 ■
Tappi alluminio: passacavo e chiuso per diffusore 14016
Aluminum caps: grommet and closed for diffuser 14016
14231-01 / 14232-01 □
Tappi bianchi: passacavo e chiuso per diffusore 14016
White caps: grommet and closed for diffuser 14016
14231-02 / 14232-02 ■
Tappi neri: passacavo e chiuso per diffusore 14016
Black caps: grommet and closed for diffuser 14016

FISSAGGIO/FIXING

14419 ■
Molletta fissa per fissaggio a parete.
Fixed clip for wall fixing.



KIT PROFILI / PROFILES KIT

Plafone
Ceiling-wall



PROFILO 1813 - fissaggio a parete con molla orientabile 14998
- Wall fixing with orientable spring 14998

INFORMAZIONI PRODOTTO:
PRODUCT INFORMATION:

Materiale profilo: Material:	Alluminio / Aluminium
Finitura: Finish:	<input checked="" type="checkbox"/> Alluminio anodizzato / Anodized aluminum <input type="checkbox"/> Bianco / White <input type="checkbox"/> Nero / Black
Materiale diffusore: Diffuser material:	Policarbonato / Polycarbonate
Diffusore: Diffuser:	Opale piano - Opale piano nero - Opale tondo - Opale alto - Prismatico UGR19 Flat opal - Flat black opal - Round opal - High opal - Prismatic UGR19
Contenuto kit: Kit contents:	Profilo+Diffusore+Tappi (1 chiuso e 1 aperto)+Mollette Profile+Diffuser+Caps (1 closed and 1 open)+Clips
Ambiente: Ambient:	Interno / Indoor
Emissione luce: Light emission:	Monoemissione / Single emission
Lunghezze disponibili: Available lengths:	1m - 2m - 3m - 4m
Grado IP: IP grade:	IP20

Unità: mm
Unit: mm

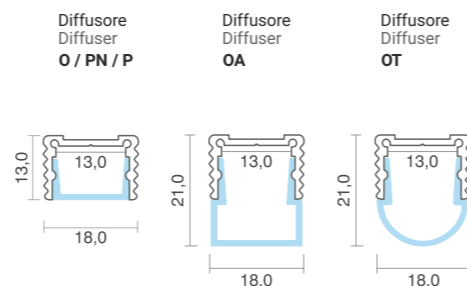

(Fig.1) (Fig.2) (Fig.3)

INSTALLAZIONE / INSTALLATION

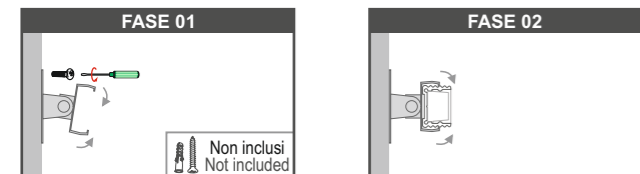

FASE 01
Orientare la staffa a DX e SX in modo da agevolare l'inserimento delle viti sulla superficie desiderata.
Orient the bracket to the right and left so as to facilitate the insertion of the onesscrews on the desired surface.

FASE 02
Fissare il profilo alla staffa con una leggera pressione.
Orientare a piacere la staffa.
Fix the profile to the bracket with alight pressure.
Orient the bracket as desired.

FISSAGGIO / FIXING

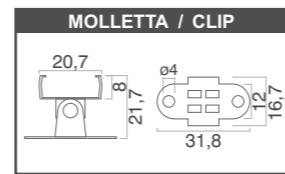

Code 14998

COMPOSIZIONE CODICE KIT
KIT CODE COMPOSITION

COD.BASE BASE CODE:	DIFFUSORE DIFFUSER	FINITURA FINISH	LUNGHEZZA LENGTH
1813-	O (opale piano/flat opal)	00 (alluminio/aluminium)	L10 (1000mm)
	PN (opale piano nero/flat black opal)	01 (bianco/white)	L20 (2000mm)
	OT (opale tondo/round opal)	02 (nero/black)	L30 (3000mm)
	OA (opale alto/high opal)		L40 (4000mm)
	P (prismatico UGR19/prismatic)		

OPZIONALE / OPTIONAL

14071
Touch SMD 12~24V (disponibile solo per copertura piana)
Touch SMD 12~24V (only available for flat cover)

CODICI COMPONENTI SINGOLI / SINGLE COMPONENTS CODES

PROFILO 1813

PROFILO/PROFILE

- 14178-L10 / 14178-L20 / 14178-L30 / 14178-L40
Alluminio L=1m/2m/3m/4m
Aluminum L=1m/2m/3m/4m
- 14178-01L10 / 14178-01L20 / 14178-01L30 / 14178-01L40
Bianco L=1m/2m/3m/4m
White L=1m/2m/3m/4m
- 14178-02L10 / 14178-02L20 / 14178-02L30 / 14178-02L40
Nero L=1m/2m/3m/4m
Black L=1m/2m/3m/4m

DIFFUSORE/DIFFUSER

- 14281-L10 / 14281-L20 / 14281-L30 / 14281-L40
Opale piano L=1m/2m/3m/4m
Flat opal L=1m/2m/3m/4m
- 14884-L10 / 14884-L20 / 14884-L30 / 14884-L40
Opale piano nero L=1m/2m/3m/4m
Flat black opal L=1m/2m/3m/4m
- 14655-L10 / 14655-L20 / 14655-L30 / 14655-L40
Prismatico L=1m/2m/3m/4m
Prismatic L=1m/2m/3m/4m

- 14929-L10 / 14929-L20 / 14929-L30 / 14929-L40
Opale alto L=1m/2m/3m/4m
High opal L=1m/2m/3m/4m

- 14016-L10 / 14016-L20 / 14016-L30 / 14016-L40
Opale tondo L=1m/2m/3m/4m
Round opal L=1m/2m/3m/4m

TAPPI/CAPS

- 13210 / 13211
Alluminio: passacavo e chiuso
Aluminum: grommet and closed
- 13210-01 / 13211-01
Bianchi: passacavo e chiuso
White: grommet and closed
- 13210-02 / 13211-02
Neri: passacavo e chiuso
Black: grommet and closed

- 14212 / 14213
Tappi alluminio: passacavo e chiuso per diffusore 14929
Aluminum caps: grommet and closed for diffuser 14929
- 14212-01 / 14213-01
Tappi bianchi: passacavo e chiuso per diffusore 14929
White caps: grommet and closed for diffuser 14929
- 14212-02 / 14213-02
Tappi neri: passacavo e chiuso per diffusore 14929
Black caps: grommet and closed for diffuser 14929

- 14231 / 14232
Tappi alluminio: passacavo e chiuso per diffusore 14016
Aluminum caps: grommet and closed for diffuser 14016
- 14231-01 / 14232-01
Tappi bianchi: passacavo e chiuso per diffusore 14016
White caps: grommet and closed for diffuser 14016
- 14231-02 / 14232-02
Tappi neri: passacavo e chiuso per diffusore 14016
Black caps: grommet and closed for diffuser 14016

FISSAGGIO/FIXING

- 14998
Molletta orientabile per fissaggio a parete.
Adjustable clip for wall fixing.

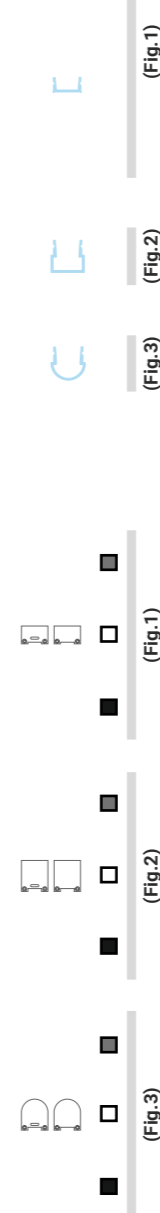

KIT PROFILI / PROFILES KIT

Plafone
Ceiling-wall



PROFILO 1813 - fissaggio a parete con molla angolare fissa 14419-IF
- wall fixing with fixed corner spring 14419-IF

INFORMAZIONI PRODOTTO:
PRODUCT INFORMATION:

Materiale profilo: Material:	Alluminio / Aluminium
Finitura: Finish:	<input checked="" type="checkbox"/> Alluminio anodizzato / Anodized aluminum <input type="checkbox"/> Bianco / White <input type="checkbox"/> Nero / Black
Materiale diffusore: Diffuser material:	Policarbonato / Polycarbonate
Diffusore: Diffuser:	Opale piano - Opale piano nero - Opale tondo - Opale alto - Prismatico UGR19 Flat opal - Flat black opal - Round opal - High opal - Prismatic UGR19
Contenuto kit: Kit contents:	Profilo+Diffusore+Tappi (1 chiuso e 1 aperto)+Mollette Profile+Diffuser+Caps (1 closed and 1 open)+Clips
Ambiente: Ambient:	Interno / Indoor
Emissione luce: Light emission:	Monoemissione / Single emission
Lunghezze disponibili: Available lengths:	1m - 2m - 3m - 4m
Grado IP: IP grade:	IP20

Unità: mm
Unit: mm

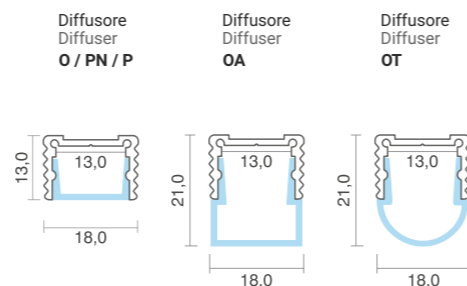

(Fig.1) (Fig.2) (Fig.3)

INSTALLAZIONE / INSTALLATION

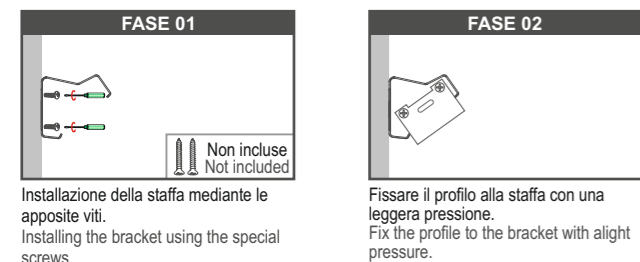

FISSAGGIO / FIXING

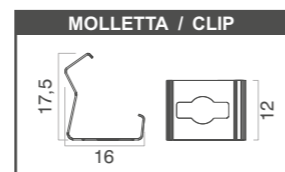

Code 14419-IF

COMPOSIZIONE CODICE KIT
KIT CODE COMPOSITION

COD.BASE BASE CODE:	DIFFUSORE DIFFUSER	FINITURA FINISH	LUNGHEZZA LENGTH
1813-	O (opale piano/flat opal)	00 (alluminio/aluminium)	L10 (1000mm)
	PN (opale piano nero/flat black opal)	01 (bianco/white)	L20 (2000mm)
	OT (opale tondo/round opal)	02 (nero/black)	L30 (3000mm)
	OA (opale alto/high opal)		L40 (4000mm)
	P (prismatico UGR19/prismatic)		

OPZIONALE / OPTIONAL

14071
Touch SMD 12~24V (disponibile solo per copertura piana)
Touch SMD 12~24V (only available for flat cover)

CODICI COMPONENTI SINGOLI / SINGLE COMPONENTS CODES

PROFILO 1813

PROFILO/PROFILE

- 14178-L10 / 14178-L20 / 14178-L30 / 14178-L40
Alluminio L=1m/2m/3m/4m
Aluminum L=1m/2m/3m/4m
- 14178-01L10 / 14178-01L20 / 14178-01L30 / 14178-01L40
Bianco L=1m/2m/3m/4m
White L=1m/2m/3m/4m
- 14178-02L10 / 14178-02L20 / 14178-02L30 / 14178-02L40
Nero L=1m/2m/3m/4m
Black L=1m/2m/3m/4m

DIFFUSORE/DIFFUSER

- 14281-L10 / 14281-L20 / 14281-L30 / 14281-L40
Opale piano L=1m/2m/3m/4m
Flat opal L=1m/2m/3m/4m
- 14884-L10 / 14884-L20 / 14884-L30 / 14884-L40
Opale piano nero L=1m/2m/3m/4m
Flat black opal L=1m/2m/3m/4m
- 14655-L10 / 14655-L20 / 14655-L30 / 14655-L40
Prismatico L=1m/2m/3m/4m
Prismatic L=1m/2m/3m/4m

- 14929-L10 / 14929-L20 / 14929-L30 / 14929-L40
Opale alto L=1m/2m/3m/4m
High opal L=1m/2m/3m/4m

- 14016-L10 / 14016-L20 / 14016-L30 / 14016-L40
Opale tondo L=1m/2m/3m/4m
Round opal L=1m/2m/3m/4m

TAPPI/CAPS

- 13210 / 13211
Alluminio: passacavo e chiuso
Aluminum: grommet and closed
- 13210-01 / 13211-01
Bianchi: passacavo e chiuso
White: grommet and closed
- 13210-02 / 13211-02
Neri: passacavo e chiuso
Black: grommet and closed

- 14212 / 14213
Tappi alluminio: passacavo e chiuso per diffusore 14929
Aluminum caps: grommet and closed for diffuser 14929
- 14212-01 / 14213-01
Tappi bianchi: passacavo e chiuso per diffusore 14929
White caps: grommet and closed for diffuser 14929
- 14212-02 / 14213-02
Tappi neri: passacavo e chiuso per diffusore 14929
Black caps: grommet and closed for diffuser 14929

- 14231 / 14232
Tappi alluminio: passacavo e chiuso per diffusore 14016
Aluminum caps: grommet and closed for diffuser 14016
- 14231-01 / 14232-01
Tappi bianchi: passacavo e chiuso per diffusore 14016
White caps: grommet and closed for diffuser 14016
- 14231-02 / 14232-02
Tappi neri: passacavo e chiuso per diffusore 14016
Black caps: grommet and closed for diffuser 14016

FISSAGGIO/FIXING

- 14419-IF
Molletta angolare fissa per fissaggio a parete.
Adjustable clip for wall fixing.

